

THE BRADLEY

Two-Bedroom, Two-Bath Terrace Home

FIRST FLOOR 1200 Square Feet*

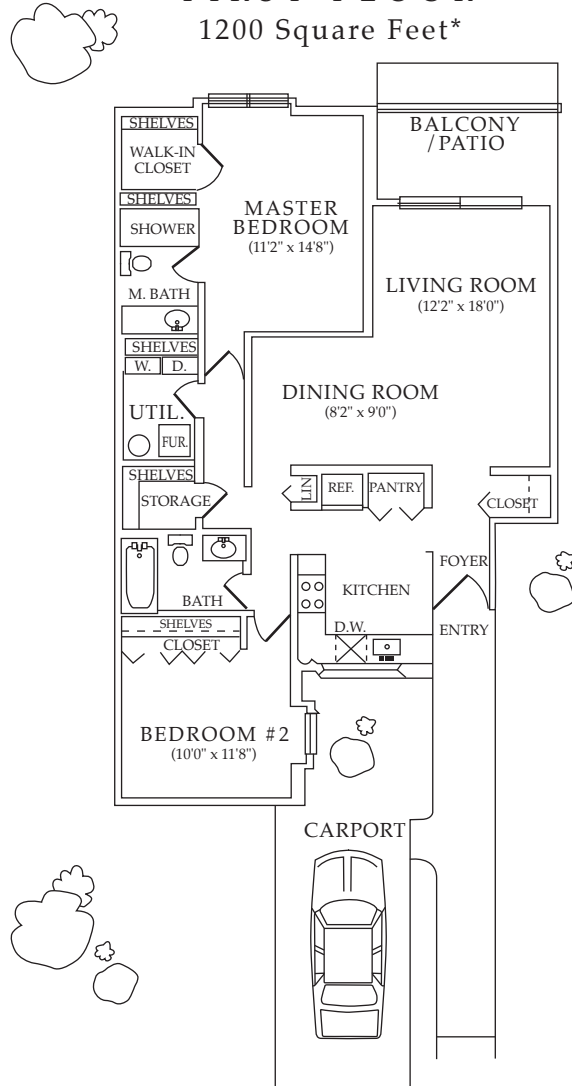

SECOND FLOOR 1250 Square Feet*

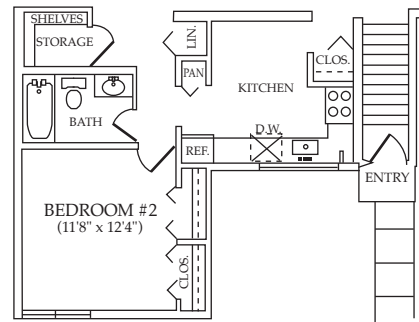

* Floorplan dimensions and room sizes may vary.
Ask your leasing consultant for details.

One of Muirwood's most luxurious Terrace Homes, The Bradley features an ingenious floorplan that creates a unique living environment that places a premium on comfort, privacy and beauty.

Highlights include:

- Through unit design
- Generous living and dining rooms with large picture windows
- Expansive dine-in kitchen with a window and a spacious pantry
- Two master-suites, each with large closets and roomy bath areas
- Large walk-in laundry room with full-sized in residence washer and dryer and a separate interior storage room
- Private covered patio/balcony
- Three exposures, yielding exceptional natural lighting and privacy
- Direct private entrance
- Private, attached covered parking

MUIRWOOD

TERRACES & APARTMENTS



**MUIRWOOD
SQUARE**

