

# The Enclave

at MUIRWOOD 

## THE NEW YORKER

Two-Bedroom, Two-Bath  
1200 Square Feet\*

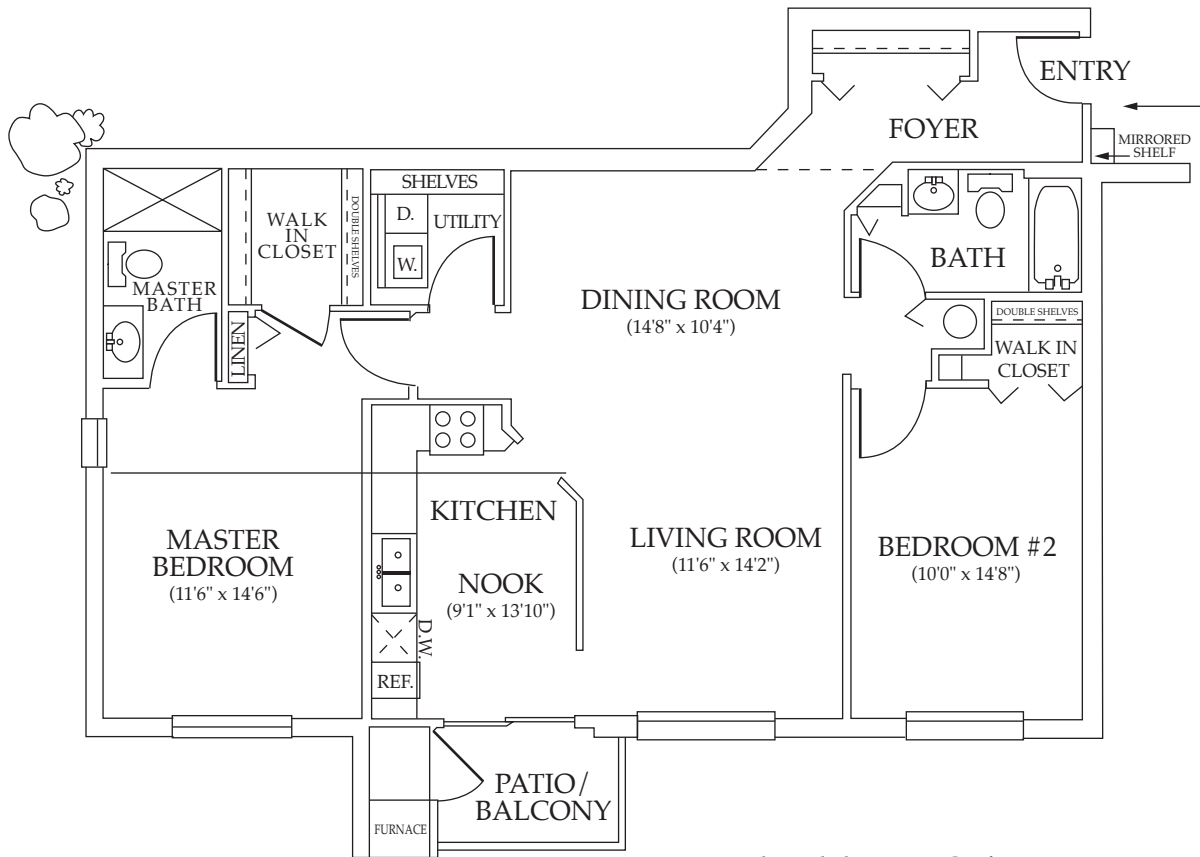

2nd & 3rd Floor Foyer Configuration

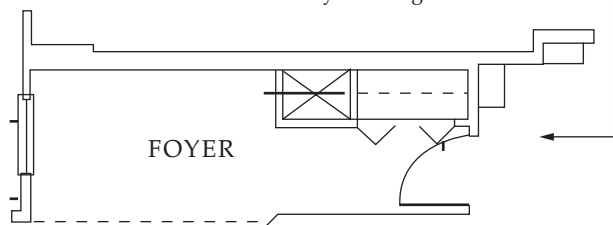

\* Floorplan dimensions and room sizes may vary.  
Ask your leasing consultant for details.

With an ample floorplan and innovative decorative touches, the 1,205 square-foot New Yorkeris designed for those who desire the spaciousness of a fine private home along with the convenience and services available within a luxury rental community.

Highlights include:

- Sumptuous lobby / club entrance
- Extra-large living / dining space with separate foyer
- Foyer features windows on all balconies
- Designed to be located on a corner for maximum privacy
- Spacious master suite with extra-large picture window and a walk-in closet
- In residence full-size washer and dryer
- Textured walls and popcorn ceilings
- Private covered parking
- Elevator access

# The Enclave

at MUIRWOOD 

## MUIRWOOD ENCLAVE

*The newest addition to the Muirwood Community*

It is our pleasure to present to you Muirwood's Enclave, a reserve community that sets a new standard for luxury and innovative rental living.

This community consists of only two three-story buildings and each is nestled beautifully into the surrounding woodlands. The buildings themselves are patterned in the style of an elegant hotel with refreshment bars and comfortable sitting areas in the lobbies, indoor mail rooms and elevator service. Likewise, the corridors to the apartments are extra wide and each apartment has its own foyer ledge and mirror outside the door for an added touch of personality.

Since its opening, the Enclave has enjoyed one of the highest demands of any rental property in Oakland County. If you have an interest in these oversized and innovative rental accommodations, we urge you to select your location today.

### ENCLAVE RESIDENCE FEATURES:

- Oversized windows provide panoramic views of the Enclave's scenic setting the moment you enter
- Exceptionally large kitchens with excellent lighting and plenty of dining space
- Private patios and balconies enabling you to enjoy the natural beauty of your surroundings
- Spacious living rooms and dining areas that are ideal for entertaining guests
- Entry foyers with spacious coat closets
- Double-hung closets for added storage capacity
- Walk-in laundry and storage rooms
- Designer coordinated cabinetry and flooring
- General Electric appliances, including in residence full-sized washers and dryers
- Convenient entry counter beside each residence's door
- Steel fire-rated entry door with dead-bolt locking system
- Personal intrusion alarm in each residence

### ENCLAVE COMMUNITY FEATURES:

- Limited community size to create a comfortable "at home" ambiance
- Two-story atrium and a gracious "hotel-styled" lobby in each building
- Centrally located elevator service in each lobby
- Elegant, spacious and well illuminated corridors
- Canopied exterior entry; electronically controlled
- Central indoor mailroom (larger packages accepted in the office)
- Optional/additional storage facilities on premises
- Convenient to downtown Farmington and Twelve Oaks Mall
- Walking distance to Muirwood Square, Rite-Aid Pharmacy and Busch's Gourmet Grocery Store
- Free membership to Muirwood Health Club with complete social programs
- Limited concierge-style services
- Minutes from I-96, I-696 and I-275

# The Enclave

at MUIRWOOD 